

YSM's COVID-19 WISHLIST

Kits for families with young children:
Diapers, different sizes
Pull ups
Wipes
Baby Formula
Baby Tylenol
Children's Tylenol
Children's cough syrup
Generic toys - balls, colouring book/markers
Food stuffs
Potatoes
Carrots
Mushrooms
Pasta
Pasta sauce
Milk
Dry cereal
Bread
Rice
Dry beans /Lentils
Eggs
condiment (e.g. ketchup, chili flakes, chilli, dried curry)
Hygiene Kits
Laundry soap
Body/bath soap
Hand soap
Feminine Products
Deodorant
Socks
Adult Ibuprofen
Disposable Razors
Toothbrush
Toothpaste
Paper towels
Toilet Paper
Hand Sanitizer

YSM's Call for fabric masks

How you can help, inspired by Michael Garron Hospital



Why does YSM need fabric masks?

With the current COVID-19 pandemic there is a worldwide shortage of personal protective equipment, otherwise known as PPE. In order to keep our community healthy and safe, YSM is asking sewers in the community to make masks to be donated to YSM staff and volunteers working to serve and support our community members at this time.

Who are the masks for?

1. All YSM staff and volunteers working behind the front lines preparing food baskets, takeaway meals and tele-counselling services, in order to keep our community healthy and safe. (note: front line staff are issued surgical masks).

What will I need to make a mask?

We are promoting a simple 2-ply, pleated mask design.

Along with standard sewing supplies (sewing machine, measuring tape, etc.), you will also need:

1. Dark-coloured polyester fabric for the outside of the mask (this could be substituted with 100% cotton if polyester is not available)
2. Light-coloured 100% cotton for the part of the mask that goes against the skin
3. Elastic for ear loops (note: If elastic is not available, cloth ties can be used)

Please use clean fabric to make the masks. YSM will also wash all masks before distributing them.

Where do I deliver the sewn masks?

We ask that a minimum of 10 masks be sent in at a time to best manage staff time and exposure. Please put your sewn masks in an envelope with your contact information (name, address, email address and phone number). It would be helpful if you could separate your masks by sizes, for example, women vs men, small vs. large (note, we do not need children's masks at this time).

Providing your contact information is optional and will be used by YSM to thank you for responding to our appeal, and for future communications.

The masks can be mailed to YSM's Evergreen Centre for Street-Involved Youth care of Marisa Bannavong, at 365 Spadina Avenue, Toronto Ontario M5T 2G3.

Instructions for Masks

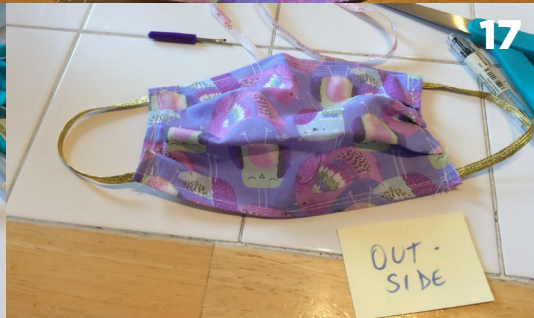
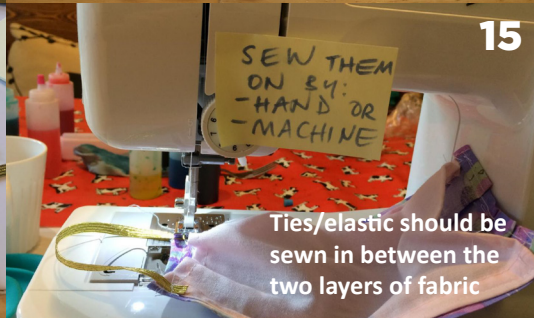
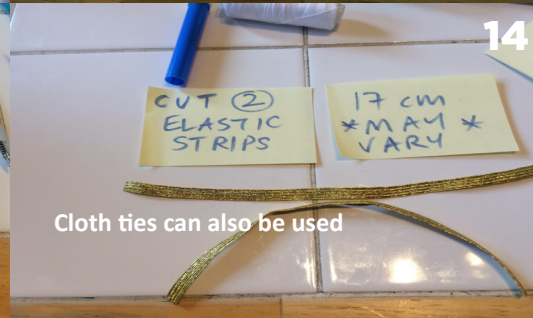
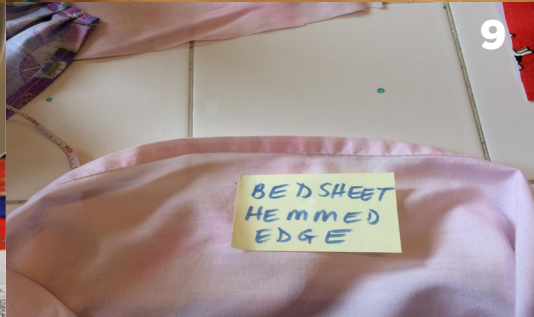
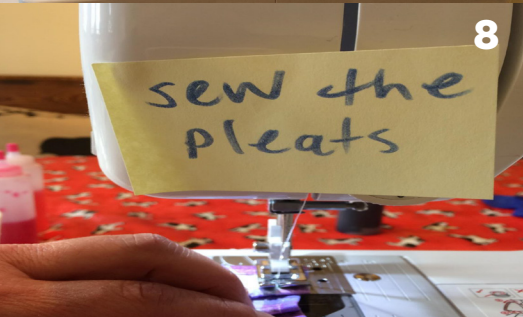
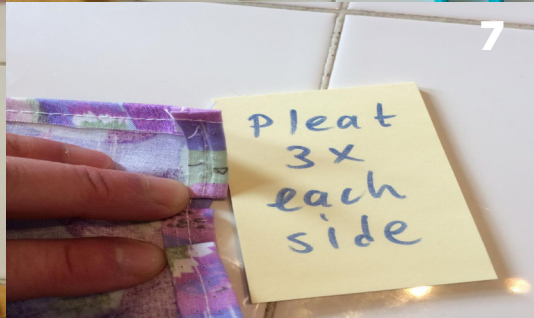
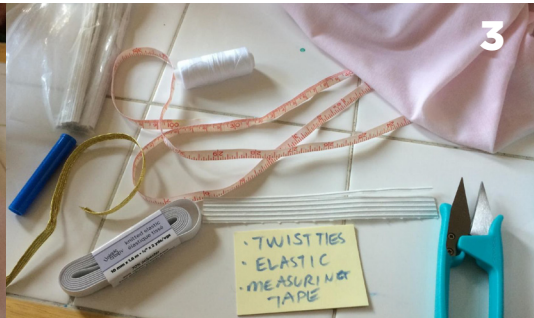

Mask Design by Michael Garron Hospital

